



**KSR + C-SR**



KSR+C-SR



KSR

	B		e		H		A		CTA		GS		GC		i304		i316	
	mm	inch	mm	mm	inch	mm	inch	kg	lb	REF.	kg/ud	REF.	kg/ud	REF.	kg/ud	REF.	kg/ud	
C-SR 100	100	4"	1,5	67	2 2/3"	30	1 1/6"	102	225	2/18543	0,23	2/18545	0,26	2/17815	0,23	2/18541	0,23	
C-SR 150	150	6"	1,5	67	2 2/3"	30	1 1/6"	102	225	2/18544	0,29	2/18546	0,32	2/17816	0,29	2/18542	0,29	
C-SR 200	200	8"	1,5	67	2 2/3"	30	1 1/6"	102	225	2/7264	0,36	2/3460	0,39	2/17817	0,36	2/18409	0,36	
C-SR 300	300	12"	1,5	67	2 2/3"	30	1 1/6"	90	198	2/7265	0,49	2/1032	0,53	2/17818	0,49	2/18410	0,49	
C-SR 400	400	16"	1,5	100	4"	60	2 3/8"	159	351	2/7266	0,81	2/1033	0,88	2/17819	0,81	2/18411	0,81	
C-SR 500	500	20"	1,5	100	4"	60	2 3/8"	134	295	2/7267	0,97	2/1034	1,06	2/17820	0,97	2/18412	0,97	
C-SR 600	600	24"	1,5	100	4"	60	2 3/8"	117	258	2/7268	1,14	2/1035	1,25	2/17821	1,14	2/18413	1,14	
KSR	-	-	2	-	-	-	-	-	-	-	-	2/6828	0,35	2/18078	0,33	2/18414	0,33	

KSR → 1 x CT2 M8X75 (2/6793) + 2/100 B2 (2/6792-GC)

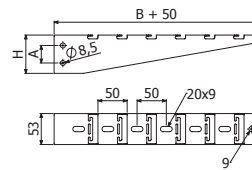

C-SR

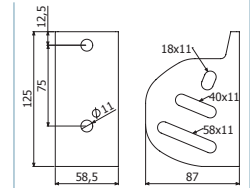

KSR

**SHST**



	L		e	CTA		GS	
	mm	inch		kg	lb	REF.	kg/ud
SHST 100	100	4"	1,5	150	331	2/14489	0,20
SHST 150	150	6"	1,5	150	331	2/14490	0,26
SHST 200	200	8"	1,5	150	331	2/14491	0,31
SHST 300	300	12"	2	150	331	2/14492	0,42
SHST 400	400	16"	2	120	265	2/14493	0,54
SHST 500	500	20"	2	100	221	2/14494	0,65
SHST 600	600	24"	2	100	221	2/14495	0,76

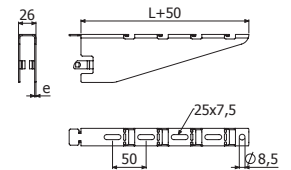

B1 (2/4356-EZ / 2/6826-GC)

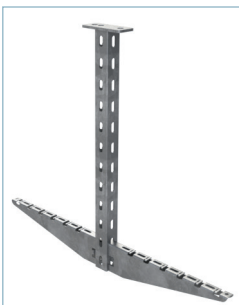

SP3S + SHST

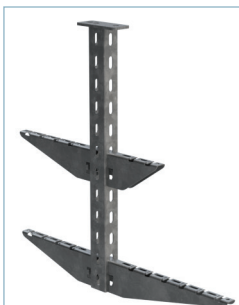

SU + SHST